



For Lease

39 Plymouth Street
Fairfield, NJ 07004

Building Specifications – Unit G

- Building Size: 53,788 Total SF
- Available Office Area: 4,602 SF (Unit G) - 2nd Floor Space
- Units: This space can be divisible to two units of +/-2,301 SF
- Parking Spaces: 12
- Location: Conveniently located in Fairfield directly off of Route 46 and I 80, I 280 and I 287

Jenna Imperatore
Senior Vice President
+1 201 528 4418
jenna.imperatore@am.jll.com

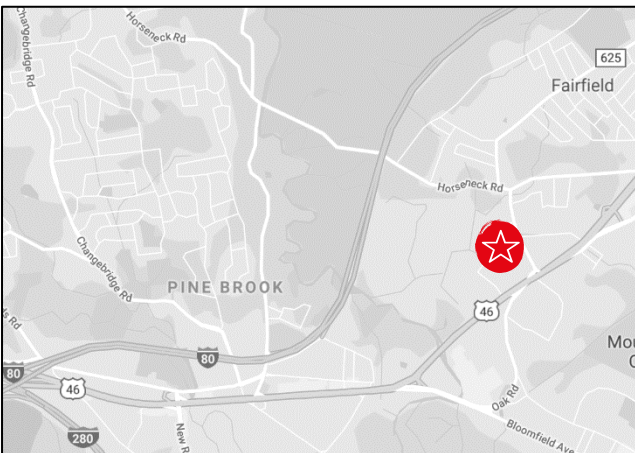

Floor Plan

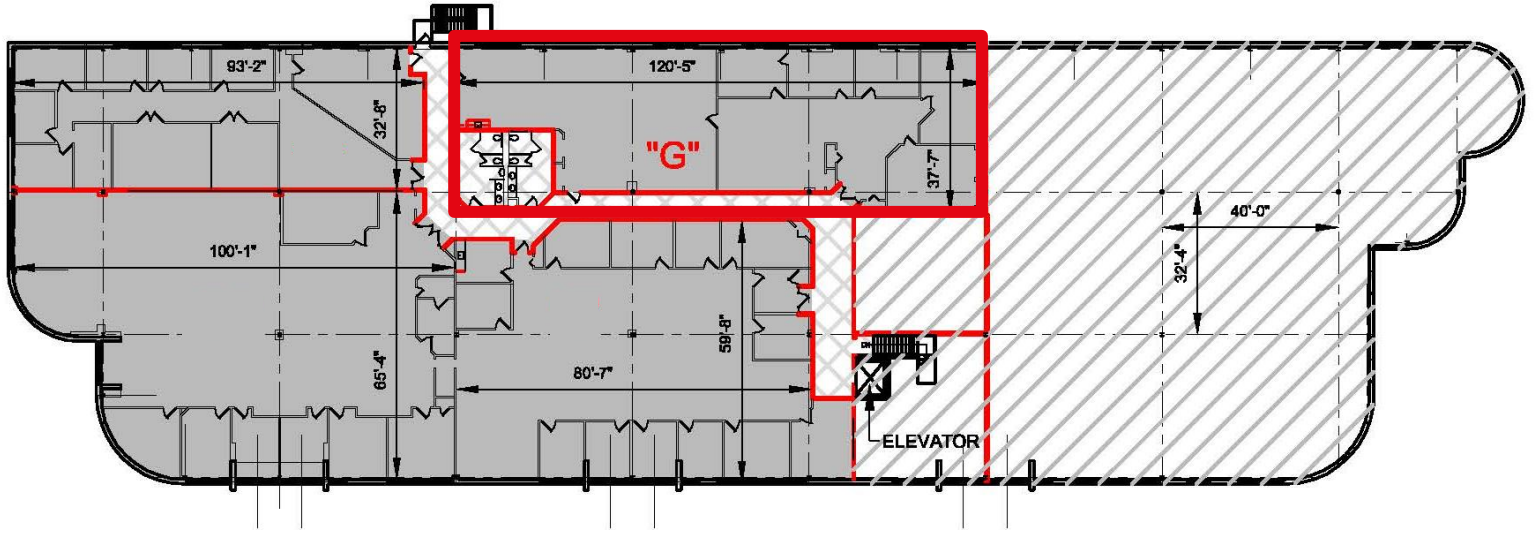

Access Map

